

GENERAL

Caproco has designed a dual disc coupon holder assembly that offers the same advantages as the standard flush disc coupon holder, with the added advantage of trap monitoring.

The coupon flush with the pipe wall monitors conditions along the pipe wall. By locating the access fitting at the bottom of the line (6 O'Clock) position, the access fitting acts like a liquid trap, so that the second coupon measures conditions of trapped liquids. This allows operators to measure the effects of any standing liquid or "low spots" in the line.

APPLICATION

With the use of the Caproco access fitting, retriever and service valve, the dual disc coupon holder allows for easy, rapid changing of coupons without system shutdown.

Dual disc coupon holders are supplied complete with Teflon spacers to insulate the coupons from each other while providing the correct orientation in the line.

SPECIFICATIONS

Caproco dual disc coupon holders are manufactured from 316 stainless steel.

| | |
|-------------------------------|-------------------------|
| Maximum Operating Pressure | 3,600 psi (24.8 MPa) |
| Maximum Operating Temperature | 500°F (260°C) |

Holders of any length or material are available upon request. Dual disc coupon holders are designed to be mounted on a Caproco solid plug through a 2" access fitting.

**CONTACT CAPROCO FOR PART NUMBER
AND SIZING INFORMATION**

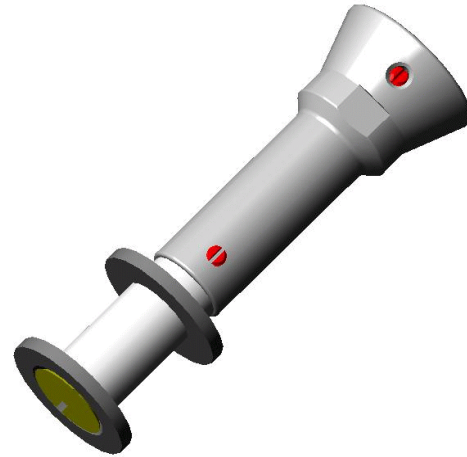

ORDERING INFORMATION

1. Access fitting height (distance from top of access fitting - cover off, to line O.D.)
2. Nominal pipe size
3. Pipe wall thickness

